

Door width calculation/Türbreitenberechnung

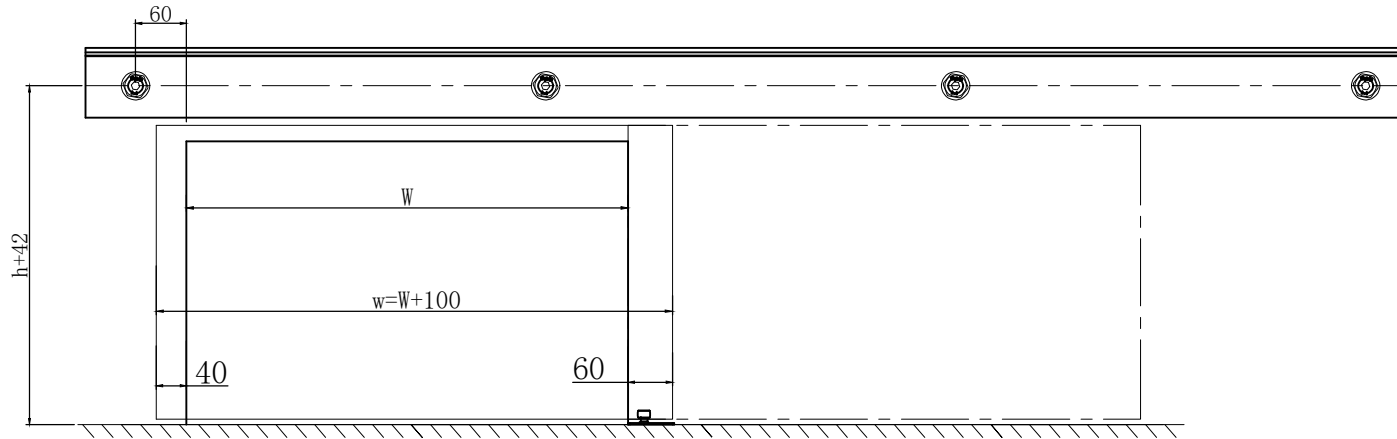

Door panel processing parameters/Tür Bearbeitungsparameter

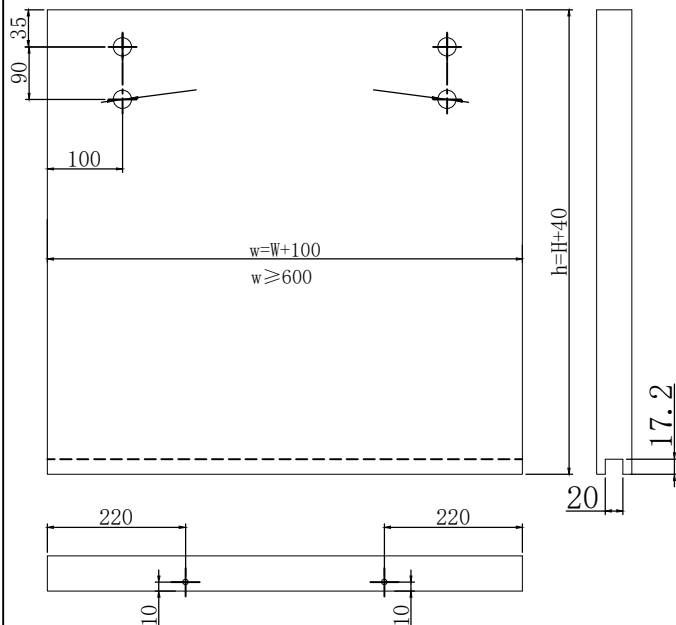

Damper/Dämpfer

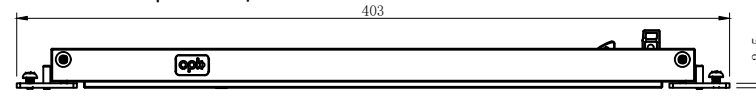

Running part / Laufwerk

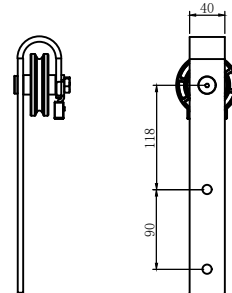

Running track / Laufschiene

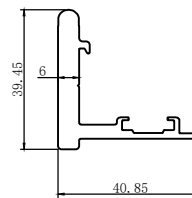

Guiding track wood / Führungsschiene Holz

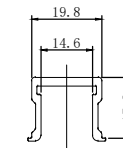

Floor guide 1 roller wood / Bodenführung 1 Rolle Holz

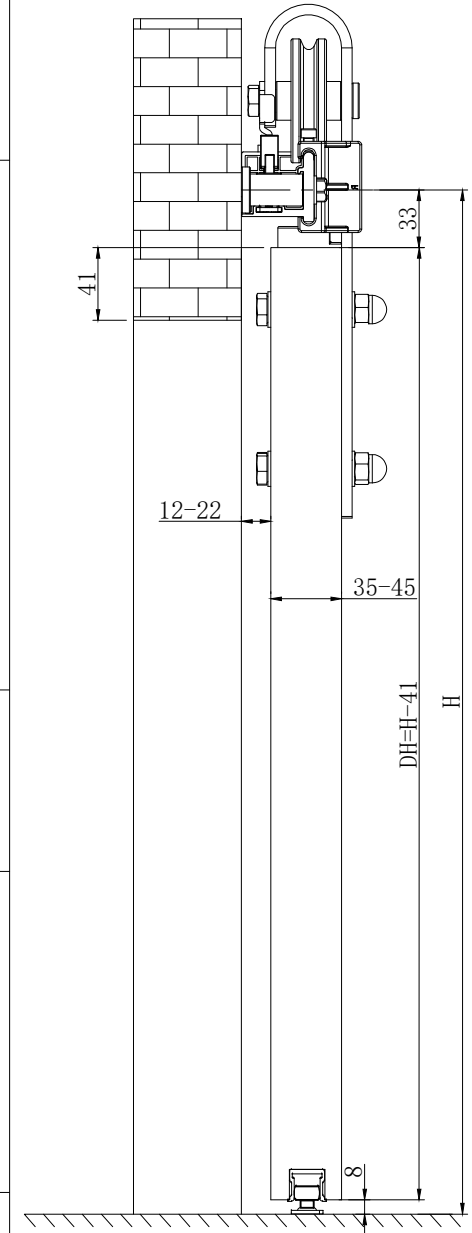
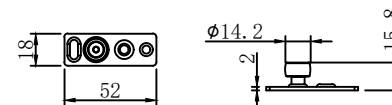

<p>OPK Europe GmbH Junghansstraße 16 72160 Harbarnhagen Neckar</p>	<p>Creator:XY</p>	<p>Name: opk Navigator 3</p>	
	<p>Description: Application for wall mounting wood sliding door. Door panel installation height is adjustable.</p>	<p>Ratio/Verhältnis: 1:2</p>	<p>Format: A3</p>
	<p>Date/Datum: 23/05/19</p>	<p>Page / Seite: 1/1</p>	
	<p>72160 Harbarnhagen Neckar</p>		